

Pennsylvania

Water



Exhibitor Prospectus

Environment

Association



PENNTec 2012 
84th Annual Technical Conference & Exhibition

June 3-6, 2012

Penn Stater Conference Center Hotel, State College, PA

PennTec 2012 Preliminary Schedule

(as of December 28, 2011)

Visit www.pwea.org for the most current program schedule.

Sunday, June 3

- 9:00am Golf Tournament
- 5:00-7:00pm Networking Reception in Exhibit Hall

Monday, June 4

- 7:00-8:00am Continental Breakfast in Exhibit Hall
- 7:30-11:30am Concurrent Morning Sessions
 - Collection Systems*
 - Engineers*
 - Nutrient Removal Technology*
 - Utility Management*
- Specialty Workshops
 - Water Reuse*
 - Activated Sludge (Day 1)*
- 7:30am-4:30pm
- 7:30am-5:30pm
- 9:00-10:00am Morning Break in Exhibit Hall
- 11:30am-1:00pm Complimentary Lunch in Exhibit Hall
- 12:30-1:00pm Annual Business Meeting with Dessert
- 1:00-3:30pm Facility Tour (Bus departs at 12:30pm)
- 1:00-4:30pm Concurrent Afternoon Sessions
 - Collection Systems*
 - Engineers*
 - Nutrient Removal Technology*
 - Utility Management*
- 2:40-3:40pm Afternoon Break in Exhibit Hall
- Operator Olympics
- 4:30-6:00pm President's Reception in Exhibit Hall
- 6:00-9:00pm Annual PWEA Dinner & Awards Ceremony

Tuesday, June 5

- 7:00-8:00am Continental Breakfast in Exhibit Hall
 - 7:30-11:30am Concurrent Morning Sessions
 - Biosolids*
 - Collection Systems*
 - Industrial Waste Pretreatment*
 - Research*
 - Water Reuse*
 - Specialty Workshops
 - Laboratory*
 - Safety*
 - Activated Sludge (Day 2)*
 - 7:30am-3:30pm
 - 7:30-11:30am
 - 7:30am-5:30pm
 - 9:00-10:00am Morning Break in Exhibit Hall
 - Research Poster Presentations in Exhibit Hall
 - 11:30am-1:30pm Complimentary Lunch in Exhibit Hall
 - 1:30-5:00pm Concurrent Afternoon Sessions
 - Biosolids*
 - Collection Systems*
 - Industrial Waste Pretreatment*
 - Water Reuse*
 - YP Professional Development*
 - 3:10-4:10pm Beer & Pretzels Break in Exhibit Hall
 - 3:45-4:10pm Announcements in Exhibit Hall
 - 5:30-8:30pm "Are You Smarter than a YP?" Social Event
- ## Wednesday, June 6
- 7:00-8:00am Continental Breakfast
 - 8:00-11:00am Morning Session
 - Grants & Financing Challenges*
 - Specialty Workshops
 - Security*
 - Activated Sludge (optional exam review)*
 - 8:00am-2:30pm
 - 8:00-11:30am
 - 12:00pm Conference Concludes



Vendor Invitation

Dear Vendor,

We invite you to join us as an exhibitor, a sponsor, and/or an advertiser for the Pennsylvania Water Environment Association's 84th Annual Technical Conference & Exhibition (PennTec 2012), which will be held at the Penn Stater in State College, PA on June 3-6, 2012.

This Conference draws more than 650 wastewater and water professionals seeking the latest knowledge and technology available in this field. You need to be there to get the word out about your products, equipment, and services!

In addition to booth space, we offer various sponsorship opportunities as well as advertising space in the On-Site Conference Program. Details can be found within the pages of this Prospectus.

Please take a moment to review our Exhibit Hall Floor Plan and the other information included here. The Exhibit Hall has sold out prior to the contract deadline the last several years. If you would like to participate in PennTec 2012, please don't delay—send in your contract right away!

Chuck Music

Chair, PennTec 2012 Conference Committee

Marilyn Baron

Chair, Exhibits & Sponsors Subcommittee

Table of Contents

| | |
|---|-------------------|
| About PWEA | 9 |
| Advertising | 8 |
| Exhibit Floor Plan | 10 |
| Exhibit Space Contract | 11 |
| General Information | 4-5 |
| Hotel Information | Back Cover |
| Important Date & Times | 4 |
| Preliminary Schedule | 2 |
| Sponsorships | 6-7 |

QUESTIONS?

Cindy Rock, PWEA Meeting Manager
Email: pweameetings@npacc.net
Phone: 570-549-2204
Fax: 570-549-2221

General Information

PWEA is committed to making your experience at our Conference as productive as possible. We will do our best to get the attendees into the Exhibit Hall—then it's up to you to attract them to your booth.

NEW! Conference Raffle Prizes

Instead of the numerous smaller denomination prizes we've raffled in the past, this year we will raffle six (6) higher valued items at different times throughout the Conference. Attendees will be given six raffle tickets, and there will be six marked containers placed randomly throughout the Exhibit Hall—one for each prize. Attendees may put as many of their tickets as they'd like in each marked container. Raffle tickets will be drawn in the Exhibit Hall on Monday during lunch, the afternoon break, and the President's Reception and on Tuesday during the morning break, lunch and the Beer & Pretzels Break. The exact prizes are to be determined, but the value of each prize will be approximately \$500-750. The attendees must be present to win. Exhibitor representatives are not eligible for these drawings.

Networking Reception

A reception is planned for Sunday evening, 5:00-7:00pm, for attendees and exhibitors to network in the Exhibit Hall before the Conference begins first thing Monday morning.

President's Reception

The President's Reception will be held in the Exhibit Hall on Monday, 4:30-6:00pm. Festivities will include one of the door prize raffles and refreshments.

Beer & Pretzels Break

Vendors at previous Conferences suggested this as a way to draw attendees into the exhibit area. Complimentary beer, root beer, and soft pretzels will be served in the Exhibit Hall on Tuesday afternoon.

Annual Dinner

Join us on Monday evening to celebrate the PWEA and WEF Award winners. The event will be held at a special venue. Details will be announced later. Attendance is complimentary to those with a paid full Conference registration. Your first two booth reps are eligible for complimentary tickets. Those with other types of registration may purchase tickets to attend.

Massage Therapists

Two massage therapists will be giving chair massages in the Exhibit Hall on Monday and Tuesday. Anyone with a badge to access the Hall is eligible to schedule a massage.

Sewer Bowl

The Sewer Bowl will be in the Exhibit Hall again this year. This fun competition is open to registrants and vendors. Cash prizes will be awarded for the top scores.

Food Stations

Food and break stations will be located in the exhibit areas. Food functions will include the receptions, continental breakfasts, coffee breaks, and lunch on Monday and Tuesday.

Exhibitor Booth Drawings

We encourage you to hold your own raffles within your booth space. PWEA will not be involved in selecting the winners of your raffles but we can announce the winners over the PA system at 3:45pm on Tuesday. In order to have your raffle winners announced, you must bring the following information to the Registration Desk by 1:00pm on Tuesday: your company name, booth number, a short description of the prize, and the winner's name. A form will be provided for your convenience.

Names received after 1:00pm will not be read by PWEA.

Important Dates and Times for the Exhibit Hall

Exhibit set-up will be on Sunday, June 3rd, 11:00am-4:00pm. If an exhibit is not set by 4:00pm, the exhibitor must wait to set up between 6:00-7:00am on Monday. Exhibitors may not set up their booths during open exhibit hours. The Exhibit Hall will be open during all program hours. **Individual booths may close during sessions at the discretion of booth representatives.**

Sunday, June 3

11:00am-4:00pm Exhibitor Set-up
5:00-7:00pm Networking Reception

Monday, June 4

7:00-8:00am Continental Breakfast
7:00am-6:00pm Exhibit Hall Open
9:00-10:00am Morning Break
11:30am-1:00pm Lunch
2:40-3:40pm Afternoon Break
4:30-6:00pm President's Reception

Tuesday, June 5

7:00-8:00am Continental Breakfast
7:00am-4:10pm Exhibit Hall Open
9:00-10:00am Morning Break
11:30am-1:30pm Lunch
3:10-4:10pm Beer & Pretzels Break
3:45pm Booth Raffle Winners Announced
4:15pm Exhibit Representative Drawing
4:15-6:00pm Exhibit Teardown

Exhibit Hall Opening

The Exhibit Hall will open on **Monday morning at 7:00am**. Booths must be set by 4:00pm on Sunday.

Exhibit Booth Information

Booths are available in several sizes. See floor plan on page 10. All booths include pipe & drape back and sides; a 6' draped table; two chairs; a wastebasket; a standard header sign; carpet; and one standard 110v electric service.

Booth reservations will be accepted on a first-come, first-paid-in-full basis. Space for oversized pieces of equipment is available in a nearby parking lot. Oversized equipment space is only available to companies who also reserve a booth.

Booth Confirmations and Exhibitor Kits

A confirmation email will be sent to you by PWEA after receipt of your exhibit contract and payment. This email will include your booth assignment, registration forms, and other information.

An Exhibitor Kit will be provided by our exposition company, General Exposition Services (GES). The kit contains additional exhibit information and forms for services such as rentals of furniture and accessories, drayage and labor services, etc.

Booth Worker Registration

The cost of an exhibit booth includes two complimentary Conference registrations for booth representatives. Two additional representatives may register at the discounted exhibitor rate. Registration forms will be provided with your booth confirmation.

A maximum of four representatives will be permitted per contracted booth. One form for each representative, including any payment due, must be received by May 18, 2012.

Cash Drawings for Booth Representatives

Representatives who submit a completed exhibitor evaluation form will be given a raffle ticket to enter this drawing. In order to claim the prize, the winner's booth must be completely set up at the time of the drawing at 4:15pm on Tuesday.

Rules, Policies, etc.

While the PWEA makes every effort to provide for a successful Conference, please be advised that there are factors which are not under the direct control of the PWEA—such as air conditioning, lighting, power, and weather.

Exhibit Rules and Regulations

Please be sure to read the PWEA Exhibit Rules and Regulations included in your Exhibitor Kit. You may request a copy in advance by calling or emailing the PWEA Meeting Manager.

Indemnification Policy

Each exhibitor assumes entire responsibility and liability for losses, damages, and claims arising out of the exhibitor's activities on the premises and will indemnify, defend and hold harmless the Facility and PWEA, their agents, servants and employees from any and all such losses, damages, and claims.

Security Policy

No one will be allowed inside the Exhibit Hall at any time without a Conference badge. While security will be provided inside the Exhibit Hall during off hours, we strongly advise you do not leave expensive items, such as laptops, unattended in your booth. The PWEA will not be held liable for any missing property.

Cancellation Policy

Booth cancellations received in writing on or before April 29, 2012, will receive a full refund less a \$100 processing fee. Cancellations received after that date, will not receive a refund.

No-Conflict Policy

Hospitality events may not be held during scheduled Conference functions. Hospitality promotions must be handled by private invitation from within the exhibitor's booth. No announcements or signs will be permitted outside the contracted booth space.

| What's included with your Registration? | Sunday Networking Reception | Monday Continental Breakfast; AM & PM Breaks; Lunch | Monday President's Reception | Monday Annual Dinner | Tuesday Continental Breakfast; AM & PM Breaks; Lunch | Wednesday Continental Breakfast; AM Break | Regular Conference Sessions | Specialty Workshops |
|--|---------------------------------------|---|--|--------------------------------|--|--|-----------------------------|---------------------|
| Complimentary Booth Workers (Reps 1 & 2) | Yes | Yes | Yes | Yes | Yes | Yes | Yes | No |
| Discount Booth Workers (Reps 3 & 4) | Yes | Yes | Yes | No | Yes | Yes | Yes | No |

New This Year

We offer a 4% discount on all payments made by check. Fees are listed for both credit card and check payments.

PWEA Annual Business Directory

PennTec 2012 exhibitors, sponsors, and advertisers are eligible for inclusion in the 2013 Annual Business Directory which is printed in the first quarter issue of the Keystone Water Quality Manager magazine. Each company will receive a complimentary listing in one category. A form with the list of categories will be sent to the contact person identified on the contract.

Sponsorships

PennTec 2012 Sponsorship Contract

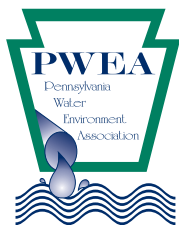

Company: _____
 Contact Name: _____
 Address: _____
 City: _____ State: _____ Zip: _____
 Phone: _____ Fax: _____
 Email: _____

Sponsorship Categories *(check all categories that apply and circle appropriate prices)*

| | Exhibitor Pricing | | Non-Exhibitor Pricing | | Total |
|---|-------------------|-------|-----------------------|-------|----------|
| | Credit Card | Check | Credit Card | Check | |
| <input type="checkbox"/> Logo Placement in the On-Site Conference Program | \$26 | \$25 | n/a | n/a | \$ _____ |
| <input type="checkbox"/> Beer & Pretzels Break Sponsor | \$78 | \$75 | \$130 | \$125 | \$ _____ |
| <input type="checkbox"/> Golf Hole Sponsor | \$104 | \$100 | \$156 | \$150 | \$ _____ |
| <input type="checkbox"/> Operator Olympics Sponsor | \$104 | \$100 | \$156 | \$150 | \$ _____ |
| <input type="checkbox"/> "Are You Smarter Than a YP?" Event Sponsor | \$130 | \$125 | \$208 | \$200 | \$ _____ |
| <input type="checkbox"/> Massage Therapist Sponsor | \$208 | \$200 | \$286 | \$275 | \$ _____ |
| <input type="checkbox"/> NEW! Conference Raffle Prize Sponsor | \$260 | \$250 | \$338 | \$325 | \$ _____ |
| <input type="checkbox"/> Monday Lunch Buffet Sponsor | \$520 | \$500 | \$754 | \$725 | \$ _____ |
| <input type="checkbox"/> Tuesday Lunch Buffet Sponsor | \$520 | \$500 | \$754 | \$725 | \$ _____ |
| <input type="checkbox"/> Annual Dinner Sponsor | \$520 | \$500 | \$754 | \$725 | \$ _____ |
| <input type="checkbox"/> Logo Placement on Registrant Gift | \$520 | \$500 | \$754 | \$725 | \$ _____ |
| Total Sponsorships | | | | | \$ _____ |

Golf Foursome Registration

Foursomes are offered at a discount. To register a single golfer, use the appropriate Conference Registration Form.

| # of Foursomes | Credit Card | Check | Total |
|----------------|-------------|-------|----------|
| _____ | \$354 | \$340 | \$ _____ |

Please provide names, if known. If more than one foursome, attach list.

1. _____ 3. _____
 2. _____ 4. _____

Method of Payment:

Check (payable to PWEA) Total if paid by Check: \$ _____

Credit Card: MasterCard Visa American Express Total if paid by Credit Card: \$ _____

Card Number: _____ Expiration Date: _____ Security Code: _____

Name (as it appears on card): _____ Signature: _____

Billing Address (if different from above): _____

Please send completed contract with full payment by APRIL 1, 2012, to:

PWEA
 Attn: Cindy Rock
 PO Box 3367
 Gettysburg, PA 17325
 Fax: 570-549-2221
 Phone: 570-549-2204
 pweameetings@npacc.net



Sponsorships

Promote your equipment, products, and services while supporting the PWEA. All sponsoring companies will be featured in the On-Site Conference Program, on signage displayed at the Conference, and in the Conference issue of the *Keystone Water Quality Manager* magazine.

Sponsorships are available for exhibiting and non-exhibiting companies.

BONUS: If you choose three or more sponsorship categories (other than the first two Logo Placement categories), you will receive one complimentary Logo Placement on the Exhibit Hall Monitor.

Fees shown are for credit card payments.

A 4% discount is available for payments made by check. See form on page 6.

(E) Exhibitor Pricing

Logo Placement in the On-Site Conference Program ♦ \$26(E)

Your company logo will be added to your company contact information printed in the Exhibitor Listing pages. Logos will print in black & white only, sized at approximately 3/4" wide by 1/2" high. Logos must be provided in electronic format by April 1, 2012.

Beer & Pretzels Break Sponsor ♦ \$78(E) or \$130(NE)

Tuesday, 3:10-4:10pm, in the Exhibit Hall

Complimentary beer and soft pretzels will be served in the Exhibit Hall. This is sure to be a big hit with the attendees, so sign up now to have your company listed as a sponsor.

Golf Hole Sponsor ♦ \$104(E) or \$156(NE)

Sunday, 8:00am, at the Tanglewood Golf Club in Lancaster

Golf hole sponsorships are used to support the Operations Challenge event at PennTec and to help send Pennsylvania teams to the national competition at WEFTEC. A golf ball sign with your company name will be displayed at the hole sponsored.

Operator Olympics Sponsor ♦ \$100(E) or \$150(NE)

Monday, 3:45pm, in the Exhibit Hall

This event is tons of fun and free to all attendees. And, this year it will be held inside the Exhibit Hall. Your sponsorship will help provide prizes. Sponsor signs will be displayed in the Olympic Arena.

"Are You Smarter Than A YP?" Event Sponsor ♦ \$130(E) or \$208(NE)

Tuesday, 5:30-8:30pm, in the Ballroom

This trivia quiz event is a huge hit with YPs (Young Professionals) and OPs (Old Professionals) alike. Sponsor logos will be printed on the answer sheets. This is a Water for People fundraiser. Electronic logos (in black only) must be received by April 29, 2012.

Massage Therapist Sponsor ♦ \$208(E) or \$286(NE)

Monday, 9:00am-2:00pm & Tuesday, 9:00am-1:00pm

Two massage therapists will give chair massages in the Exhibit Hall. Attendees and exhibitors are eligible to sign up for a massage. Sponsor this event and your company name will be displayed in the massage area.

(NE) Non-Exhibitor Pricing

NEW! Conference Raffle Prize Sponsor ♦ \$260(E) or \$338(NE)

This year we will raffle six (6) higher ticket items at different times throughout the conference. There will be six buckets placed randomly throughout the exhibit hall—one for each prize. Prizes will be raffled at different times throughout the Conference. See page 7 for more details. As a Prize Sponsor, your company will be featured on a sign posted near one of the prize buckets. No more than three companies will be featured with each prize.

Monday or Tuesday Lunch Buffet Sponsor ♦ \$520(E) or \$754(NE)

Monday, 11:30am-1:00pm, or Tuesday, 11:30am-1:30pm

Sponsor the lunch buffet and your company name will be prominently displayed. Plus you may provide a giveaway item or flyer to be placed on the tables. Items should be given to the PWEA staff on-site by 9:00am on Monday.

Annual Dinner Sponsor ♦ \$520(E) or \$754(NE)

Monday, 6:00-9:00pm, in the Ballroom

Join us at this year's Annual Dinner celebrating the PWEA and WEF Award winners. Attendance is complimentary to attendees with paid full Conference registration. Plus you may provide a giveaway item or flyer to be placed on the tables. Items should be given to the PWEA staff on-site by 9:00am on Monday.

Logo Placement on Registrant Gift ♦ \$520 (E) or \$754 (NE)

Another way to maximize exposure of your company logo is to have it imprinted on the registrant gift which will be given to all Conference attendees. The gift will be something that can be used after the Conference—something different we are considering for this year is a laptop sleeve. A maximum of two sponsoring companies will be accepted. Specifications for the logo format will be provided.

Golf Foursome Registration

The PWEA Golf Outing will be held on Sunday morning. This is a great opportunity for you to entertain your clients! For your convenience, you may sign up for a Golf Foursome on the Sponsorship form. The fee for a single golfer is \$94, but Foursomes are available for \$354 – a savings of up to \$22 per Foursome.

On-Site Program Advertising

Advertising space is available in the PennTec 2012 On-Site Conference Program. The Program is distributed to every Conference participant. **You DO NOT need to purchase exhibit space in order to advertise in the Program.** A signed contract with payment in full, a hard copy sample of the ad, and the ad in electronic format must be received by **April 1, 2012.** (No agency discount or commission is available for Conference Program advertising.)

Company Logos in Exhibitor Listing

Your company logo can be added to your company contact information printed in the Program on the Exhibitor Listing pages. Logos print in black & white only. The size of the printed logo will be approximately 3/4" wide x 1/2" high. Logos must be black & white art created in TIFF, EPS, JPEG, or PDF formats, created in high resolution with 300 dpi.

Advertising Policy

The Pennsylvania Water Environment Association (PWEA) reserves the right to reject advertising which it deems unsuitable and to refuse acceptance from advertisers of questionable credit or trade standing. Advertising which simulates reading matter will be plainly marked "advertisement" in a typeline above or below the insertion.

The PWEA reserves the right to determine the placement of all advertisements, except special position ads. The PWEA is only responsible for providing advertising space, and is not liable for the content of the advertisements appearing in the Conference Program.

Ad Requirements:

- Electronic files are required. All 4-color ads must be CMYK process. Color ads must be designed in a software program which allows color separations.
- Files must be Mac compatible. Application files must be sent with fonts and graphics individually (do not embed in file). Files may be PDF, TIFF, EPS, JPEG, or Adobe InDesign documents. All files must be created in high resolution with 300 dpi.
- Adobe Illustrator, Adobe Photoshop, or Adobe InDesign documents are preferred.
- Files should be emailed to: pwea@pwea.org or sent via CD/DVD. Please submit hard copy sample with contract.
- Any additional copy, touch up or artwork required to complete an ad will be billed to the advertiser at cost plus 10% handling charge. Please call for price quotes.

All advertisements must be received by April 1, 2012.

In the event of a cancellation, fees will be refunded less a \$50 administrative fee if the cancellation is received in writing by April 1st.

Cancellations will not be accepted after that date.



Please send completed contract with full payment by APRIL 1, 2012, to:

PWEA
PO Box 3367
Gettysburg, PA 17325
Fax: 570-549-2221
Phone: 570-549-2204

Email: pweameetings@npacc.net

PennTec 2012 On-Site Program Ad Contract

Company: _____

Contact Name: _____

Address: _____

City: _____ State: _____ Zip: _____

Phone: _____ Fax: _____

Email: _____

Advertisement Rates: (Circle your ad choices)

| Ad Size (width x height) | Black & White | | 4-Color Process | |
|--|---------------|-------|-----------------|-------|
| | Credit Card | Check | Credit Card | Check |
| Full Page (7.5" x 10") | \$234 | \$225 | \$364 | \$350 |
| Half Page (7.5" x 4.75") | \$172 | \$165 | \$302 | \$290 |
| 1/4 Page (7.5" x 2.25" or 3.75" x 4.75") | \$130 | \$125 | \$255 | \$245 |
| Business Card (3.5" x 2") | \$78 | \$75 | \$224 | \$215 |
| Company Logo | \$26 | \$25 | n/a | n/a |

Special Position Advertisements

(available on first-come basis):

| | Credit Card | Check |
|--------------------|-------------|-------|
| Inside Front Cover | \$442 | \$425 |
| Inside Back Cover | \$442 | \$425 |
| Outside Back Cover | \$442 | \$425 |

All Special Position Advertisements are Full Page and can be printed in either 4-color or black & white.

Method of Payment:

Check (payable to PWEA)

Total if paid by by Check: \$ _____

Credit Card: MasterCard Visa American Express

Total if paid by Credit Card: \$ _____

Card Number: _____ Expiration Date: _____ Security Code: _____

Name (as it appears on card): _____ Signature: _____

Billing Address (if different from above): _____



About PWEA

The PWEA membership is comprised of over 2,000 professionals involved with the water and wastewater industry in Pennsylvania. The PWEA is Member Association of the Water Environment Federation, which is a not-for-profit association that provides technical education and training for thousands of water quality professionals who clean water and return it safely to the environment. PWEA and WEF members have proudly protected public health, served their local communities, and supported clean water since 1928.

PWEA Mission Statement

To enhance the knowledge and abilities of Pennsylvania's wastewater professionals, to promote sound water policies, and to promote public awareness of the need to protect water quality.

Value of Membership

Listed below are the key points that illustrate the value and importance of membership with the PWEA.

Keystone Water Quality Manager

A nationally recognized, quarterly technical publication containing legislative updates, design/process operations articles, problem-solving case histories, and advance notice of continuing education. This valuable magazine also highlights current technology trends and issues affecting the wastewater industry.

Advertising opportunities are available.

Continuing Education

State-of-the-art technical training programs in the form of workshops, technical conferences, reference library, and technical publications designed to address continuing education requirements for water and wastewater professionals. *Limited sponsorship opportunities are available.*

Annual Technical Conference & Exhibition

Pennsylvania's largest technical conference and exposition primarily devoted to the wastewater industry. This conference attracts professionals from all areas of the country. Attend technical sessions and exhibits featuring representatives of various service industries as well as equipment manufacturers and suppliers from all over the United States. The Conference provides an opportunity to earn valuable Continuing Education credit. *Exhibiting, advertising, and sponsorship opportunities are available.*

PWEA Job Bank

Monthly email communication designed to highlight career opportunities within the state. Employers seeking qualified employees in the water environment industry or members interested in changing employers use this forum for confidential exchange of information. *Does your firm have positions to fill? Advertise them in the PWEA Job Bank.*

PWEA eNewsletter

A monthly email communication designed to provide time-sensitive information or information received after the deadline for inclusion in the Keystone Water Quality Manager. *Sponsorship opportunities are available.*

Peer Networking

Meet, network, and share experiences, problems, and solutions with other industry professionals facing similar day-to-day operating and management challenges.

Access to Regulatory Information and Officials

Obtain information about pending regulatory changes and participate in the legislative process. Meet and discuss your concerns with regulatory officials in non-adversarial settings.

Professional Development

Expand and enhance your expertise and talents to become a better educated, better trained industry professional, which will make you more valuable to an employer.

Leadership Skills Enhancement

Active participation on PWEA Committees can lead to important leadership positions within the PWEA and increase your professional standing.

Questions?

If you have questions about PWEA, or if you would like to request a PWEA Membership Application, please contact the PWEA Administrative Office at 717-642-9500 or by email at pwea@pwea.org.

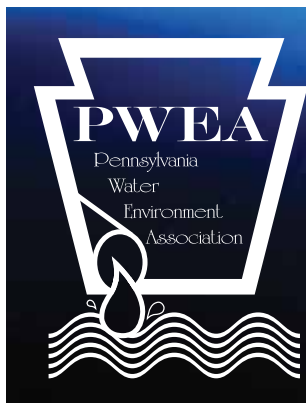
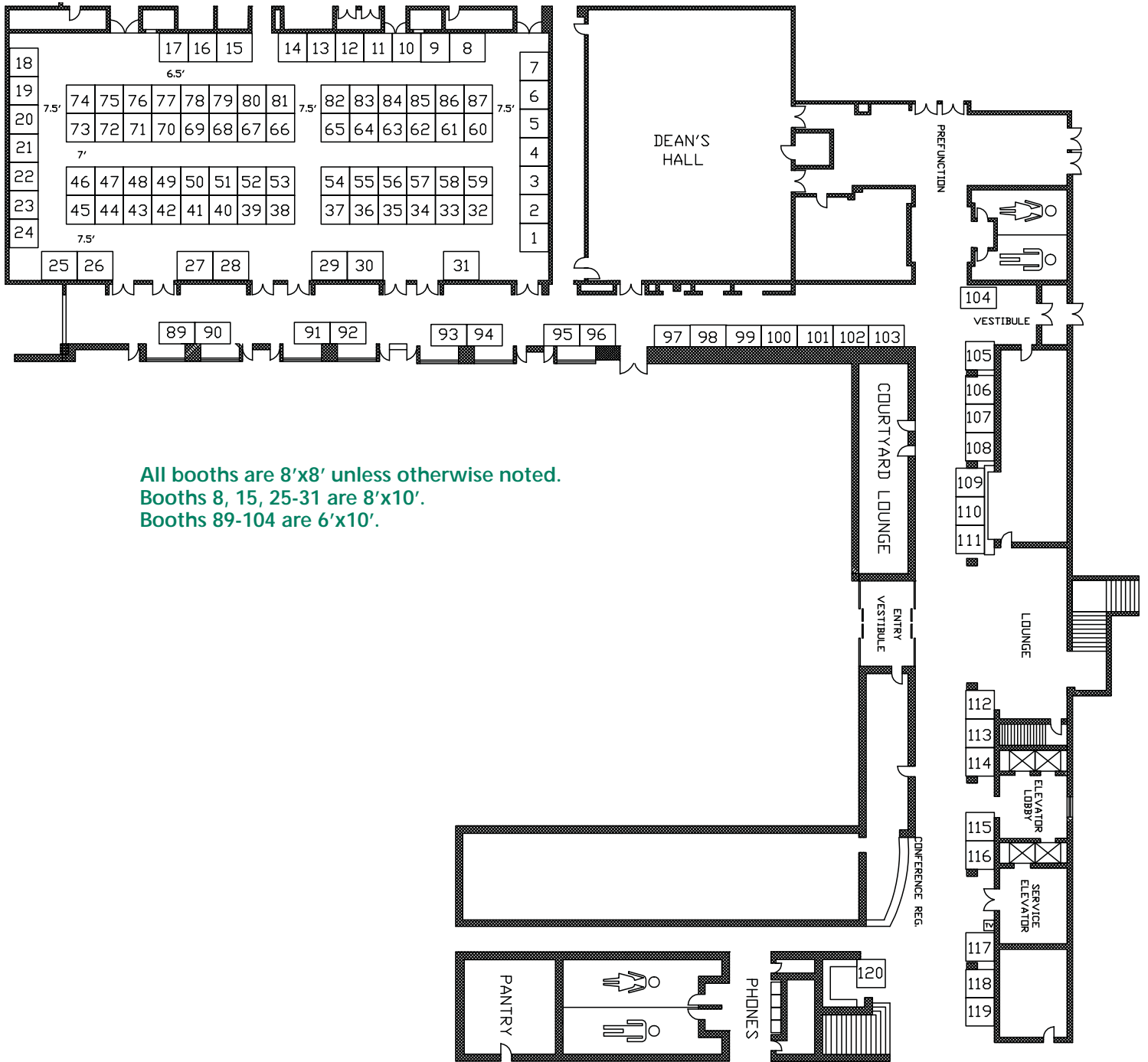

Exhibit Hall Floor Plan



All booths are 8'x8' unless otherwise noted.
 Booths 8, 15, 25-31 are 8'x10'.
 Booths 89-104 are 6'x10'.

Contract for Exhibit Space

PLEASE PRINT all information on form
PennTec 2012 – 84th Annual Technical Conference & Exhibition • State College, PA • June 3-6, 2012

Company Information – The following information will be published in the On-Site Conference Program.

Company Name: _____
 Address: _____
 City: _____ State: _____ Zip: _____
 Phone: _____ Fax: _____
 Email: _____ Website: _____

Contact Information – This is the person to whom all information will be sent.

Contact Person: _____ Email: _____
 Phone (if different than above): _____ Fax (if different than above): _____
 To qualify for Member rate, provide name of employee who is a PWEA Member: _____

Exhibit Space Fees – Booth fees include standard electric service, carpet, and two complimentary Full Conference Registrations with complimentary tickets to the Annual Dinner. **Registration Forms will be provided with your booth confirmation.**

| | Member | | Non-Member | | Quantity | Total |
|--|-------------|--------|-------------|--------|----------|----------|
| | Credit Card | Check | Credit Card | Check | | |
| 8x8 (Inside) | \$1118 | \$1075 | \$1274 | \$1225 | _____ | \$ _____ |
| 8x10 (Inside) | \$1326 | \$1275 | \$1482 | \$1425 | _____ | \$ _____ |
| 6x10 or 8x8 (Hallway) | \$1326 | \$1275 | \$1482 | \$1425 | _____ | \$ _____ |
| Outdoor Space (with Indoor Booth only) | \$260 | \$250 | \$312 | \$300 | _____ | \$ _____ |
| Total Due for Exhibit Space \$ | | | | | | _____ |

Choose one category which best describes your company. This category will be included with your listing in the On-Site Conference Program.

- Biosolids/Sludge Management
- Collection Systems Services & Equipment
- Computer Sales & Services
- Construction Consultants
- Environmental Consultants
- Laboratory Services & Equipment
- Manufacturer's Representatives/Supplies
- Maintenance Repairs/Services & Equipment
- Odor Control
- Process Chemicals
- Process Control Equipment
- Process Control Instrumentation
- Safety Equipment
- Wastewater/Waste Treatment Services & Equipment

Preferred Booth Location:

List booth numbers in order of preference: 1) _____ 2) _____ 3) _____
 Space will be assigned in the order in which fully paid contracts are received. Every effort will be made to grant your space request; however, specific requests cannot be guaranteed.

Prize Donation

I will donate a prize for the "Are You Smarter Than A YP?" Event
 Prizes should be given to PWEA staff by 12:00pm on Monday.

Agreement

By signing this Contract, I acknowledge that I am authorized to represent the Company noted on this Contract. I/we agree to abide by all PWEA Policies as outlined on page 5 and to the PWEA Rules & Regulations for Exhibiting.

Signature: _____

Method of Payment:

Check (payable to PWEA) Total if paid by Check: \$ _____
 Credit Card: MasterCard Visa American Express Total if paid by Credit Card: \$ _____

Card Number: _____ Expiration Date: _____ Security Code: _____

Name (as it appears on card): _____ Signature: _____

Billing Address (if different from above): _____

Office Use Only

Date Received: _____ Amount Paid: \$ _____ Check #: _____ CC Confirmation #: _____
 Booth Number Assigned: _____ Notes: _____

Please send completed contract with full payment by May 18, 2012, to:

PWEA
 Attn: Cindy Rock
 PO Box 3367
 Gettysburg, PA 17325
 Fax: 570-549-2221
 Phone: 570-549-2204
 pweameetings@npacc.net





Pennsylvania Water Environment Association
PO Box 3367
Gettysburg, PA 17325
www.pwea.org

NONPROFIT
U.S. POSTAGE
PAID
HARRISBURG, PA
PERMIT NO. 533

Hotel Accommodations

Penn Stater Conference Center Hotel 215 Innovation Blvd • State College, PA 16803

A block of rooms has been reserved at the Penn Stater for PennTec 2012.
Reservations must be made by May 12, 2012. Rooms may not be available after this date. The discounted room rate is as follows:

\$119.00 per Room/Single or Double Occupancy
*This rate includes overnight accommodations only.
Meals are not included. All rooms are non-smoking.*

Please call Reservations at 1-800-233-7505 and mention **Reservation ID PAWF12A** to receive the discounted rate.

